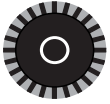
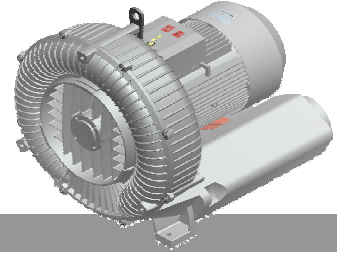

G-BH9

Data sheet 2BH9 2300

Side channel blower with IE2-motors

IE2

Performance curves

Vacuum operation (acfm)

Pressure operation (scfm)

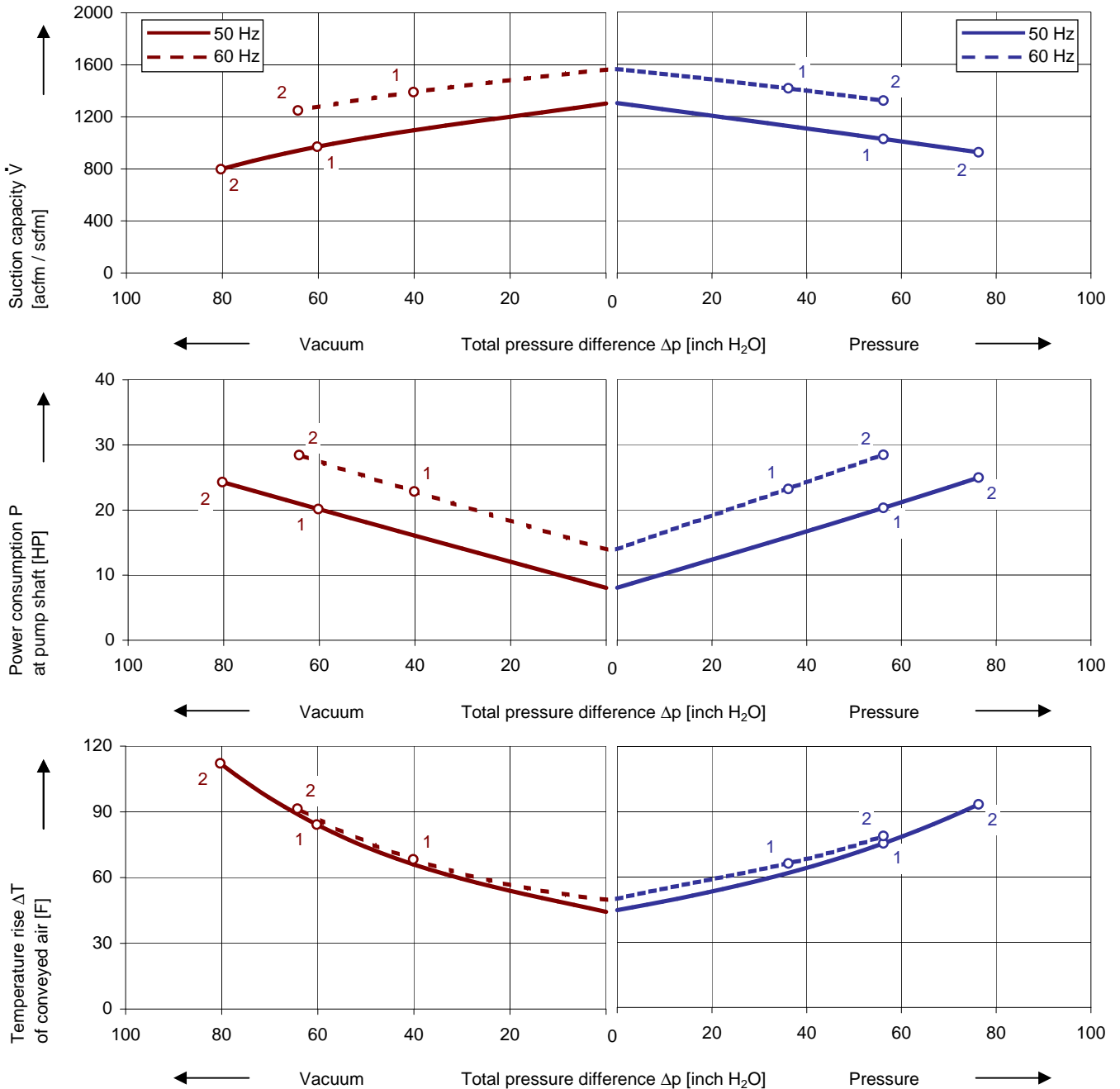

The performance curves are based on air at a temperature of 59 F and an atmospheric pressure of 29.91 inch Hg with a tolerance of $\pm 10\%$. The total pressure differences are valid for inlet and ambient temperature up to 77 F. Suction capacity relates to inlet conditions. Pressure capacity relates to atmospheric conditions. For other conditions please get in touch with us.

Every G-BH blower can be used either for vacuum or pressure in continuous operation over the total performance curve range. The motors are available as standard in protection category IP 55 and insulation class F. These blowers are UL and CSA approved.

Selection and ordering data

Type 2BH9 2300

No.	Fre- quency	Rated			Max. differential pressure ²⁾		Sound pressure level ³⁾	Weight Approx.	Order No.
		Voltage ¹⁾	Current	Power	Vacuum	Pressure			
					Hz	V			
3- 50/60 Hz, IP55, Insulation material class F, UL 507 and CSA 22.2 No 113 (certificate number E225239)									
1	50	180 - 240 Δ / 310 - 415 Y	57.0 Δ / 33.0 Y	20.1	-60	56	79	364	2BH9 2300-1AAPQ1-AA
	60	200 - 275 Δ / 345 - 480 Y	58.0 Δ / 34.0 Y	23.2	-40	36	81		
2	50	180 - 240 Δ / 310 - 415 Y	70.0 Δ / 40.0 Y	24.8	-80	76	79	408	2BH9 2300-1AAPR1-AA
	60	200 - 275 Δ / 345 - 480 Y	65.0 Δ / 37.5 Y	28.6	-64	56	81		
3- 50/60 Hz, IP55, Insulation material class F, UL 507 and CSA 22.2 No 113 (certificate number E225239)									
1	50	450 - 550 Δ	23.5 Δ	20.1	-60	56	79	364	2BH9 2300-1AAPQ5-AA
	60	520 - 600 Δ	23.0 Δ	23.2	-40	36	81		
2	50	450 - 550 Δ	28.0 Δ	24.8	-80	76	79	408	2BH9 2300-1AAPR5-AA
	60	520 - 600 Δ	28.0 Δ	28.6	-64	56	81		

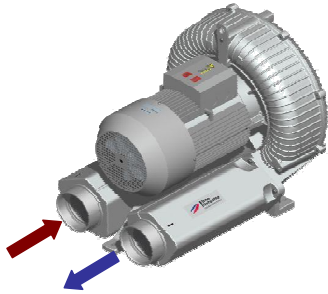

2BH9 2300-1AAPxx-AA

Discharge right
(standard)

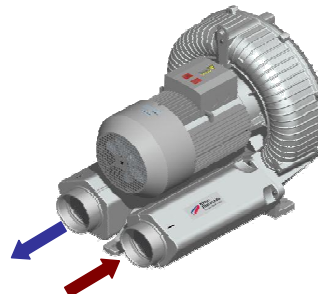

2BH9 2300-5AAPxx-AA

Discharge left
(optional)

- 1) In case of frequency converter operation the standard motor insulation system is suitable for converter input voltages up to 460 V.
- 2) Relief valves available for limiting differential pressure.
- 3) Measuring surface sound pressure level acc. to EN ISO 3744, measured with an equivalent unit at a distance of 1 m. The pump is throttled to an average suction pressure, with piping connected, but no relief valves fitted, tolerance ± 3 dB (A).

All G-BH fulfill the 2006/42/EC (machinery) and 2006/95/EC (low voltage) directives and the EN 60034-1 norm "Rotating electrical machines".

The motors comply with EN 60 034-1 / -2 / -30 (IEC 60034) and thermal class F.

The voltage tolerance is +/- 5%.

The frequency tolerance is +/- 2 % maximum.

Motors for other mains

50 Hz	50 Hz voltage range	60 Hz voltage range	2BH9.....	□	□
IE2 3-					
200 V Δ / 345 V Y	180 - 240 V Δ / 310 - 415 V Y	200 - 275 V Δ / 345 - 480 V Y		P	1
500 V Δ	450 - 550 V Δ	520 - 600 V Δ		P	5
230 V Δ / 400 V Y	200 - 260 V Δ / 350 - 450 V Y	230 - 290 V Δ / 400 - 500 V Y		P	6
400 V Δ / 690 V Y	350 - 450 V Δ / 610 - 725 V Y	400 - 500 V Δ / 690 - 725 V Y		P	7

Changes in particular of the quoted performance curve, data and weights may occur without prior notice. The data given do not constitute an obligation from our side to deliver as shown.

Elmo Rietschle is a brand of Gardner Denver

**Gardner
Denver**

Your Ultimate Source for Vacuum and Pressure

Gardner Denver Deutschland GmbH
Industriestraße 26
97616 Bad Neustadt - Germany
Tel.: +49 9771 6888-0
Fax: +49 9771 6888-4000

www.gd-elmorietschle.com • er.de@gardnerdenver.com

Gardner Denver, Inc.
1800 Gardner Expressway
Quincy, IL 62305
Tel.: +49 7622 392-0
Fax: 217-221-8780